

ARCH TOP GARAGE DOOR FRAME INSTALLATION INSTRUCTIONS

Notes: Assembly and installation of this all-aluminum arch top garage door frame requires two people.

Tools required:

- Screw gun , screw driver, or drill
- Hammer

Additional Materials Required:

- Color matching caulk
- Wood shims
- Nails or screws to fasten to rough opening

Rough Opening Requirements:

- Width: 3 inches wider than finished opening
- Height: 1-1/2 inches higher than finished opening

STEP 1: Open arched top package (1 of 2) and lay on level surface being careful not to scratch the aluminum finish. Do the same with the all-aluminum vertical legs of the door frame (package 2 of 2).

STEP 2: Open hardware package which contains 2 galvanized steel corner gussets (5 ½" jamb depth), or 4 galvanized steel corner gussets (7 ½" jamb depth), 2 each 3" drywall screws, and either 4 or 8 #6 x 2" PH screws.



STEP 3: Insert galvanized steel corner gusset(s) into end of arch top header, one (1) each for 5 ½" jamb and two (2) each for 7 ½" jamb. Gussets should be inserted up to dimple stop in cavities that align with black dot on back of arch top header.



STEP 4: Drill 1/8" pilot hole(s) at black dot locations on back of arch top header, through inserted gusset(s).



STEP 5: Using screw gun, insert one (1) # 6 x 2" PH screw from backside of arch top header into leg of each gusset.

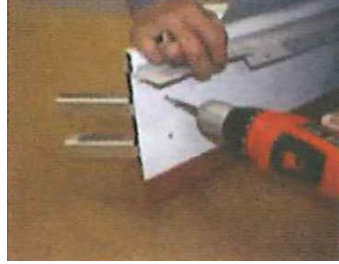

STEP 7: Using screw gun, on the backside of the vertical frame leg, through frame nailing strip, insert 3" drywall screw joining vertical leg nailing strip with header nailing strip as shown.



Assembled corner should have minimum separation between arch top and vertical leg along the exposed aluminum jamb face and nosing.



STEP 6: Insert mitered end of all-aluminum vertical frame leg into mating arch top header gusset(s). Gussets are designed to bend in center to allow arch top header and vertical leg miter to form clean tight mitered corner.



STEP 8: Drill 1/8" pilot hole(s) at black dot locations on back of vertical frame leg through inserted gussets.

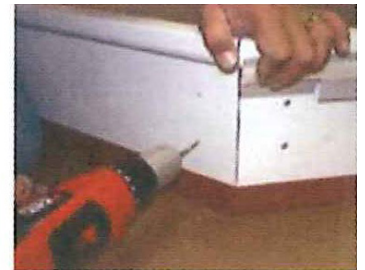

Assembled corner should have minimum separation between arch top and vertical leg along the exposed aluminum jamb face and nosing.

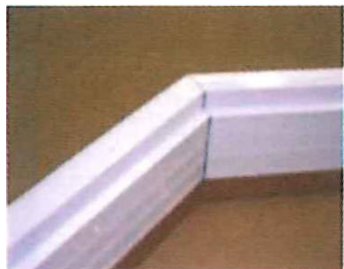

STEP 9: Using screw gun, insert one (1) # 6 x 2" PH screw from backside of vertical frame leg into leg of each inserted gusset.



Assembled corner should have minimum separation between arch top and vertical leg along the exposed aluminum jamb face and nosing.

STEP 13: Using color matched caulk (not provided), caulk face and inside miter joints as shown.



STEP 10: Assemble opposite mitered corner repeating steps 3 through 9.

STEP 11: Insert assembled frame (two people required) into rough opening. Attach frame to exterior wall surface nailing through nail fin. Nails/ screws not provided.



STEP 12: Using wood shims (not provided), shim until plumb and square vertical frame legs and arch top header, and fasten with screws or nails (not provided) through exposed nailing strip on frame verticals and arch top header.

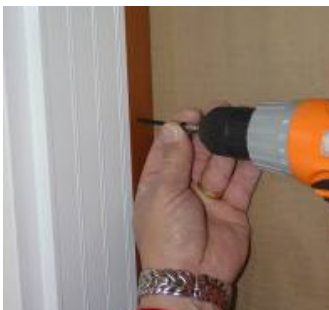

www.frontlinebldg.com | sales@frontlinebldg.com | 920-393-1340